

# CHUNKY MOVE

## Venue Hire Information

January 2024



### CHUNKY MOVE

+61 3 9645 5188  
111 Sturt St  
Southbank 3006  
VIC Australia

Hannah Brown  
Office & Program Coordinator  
[info@chunkymove.com.au](mailto:info@chunkymove.com.au)

The **Chunky Move** studios are Melbourne's premiere purpose-built dance studios. They feature large, versatile spaces, the iconic orange paneling, sprung floors, state of the art low power LED lighting, daylight from skylights, power facilities, building amenities and security.

**Chunky Move** holds developments, dance classes and performances across both studios throughout the year. Please be aware **Chunky Move** hold regular classes mornings and evenings, including weekends, and all hires are subject to the availability of the studios and the discretion of the Company.

The studios are an attractive venue for:

- Corporate Events – workshops and classes
- Performance Rehearsals – dance and theatre
- One-off Workshops & Classes – dance, theatre and yoga
- Auditions – dance and music theatre

### **Enquiries & Bookings**

For all enquiries regarding studio hire rates and availability please contact our Office & Program Coordinator on (03) 9645 5188 or [info@chunkymove.com.au](mailto:info@chunkymove.com.au)

To submit a hire request, please complete our form via our website at [chunkymove.com/about/venue-hire/](http://chunkymove.com/about/venue-hire/)

### **Technical Information**

Further details regarding technical equipment available for use during your hire will be provided on consultation with our Production & Operations Manager following the submission of a venue hire inquiry.



# Studio 1

Our larger studio, with retractable seating bank, generous skylights, sound system and sprung floor.

Regularly used for rehearsals, creative developments, performances, and presentations as well as our Classes Program.

This is a dynamic space that changes regularly to meet the needs of the Company.

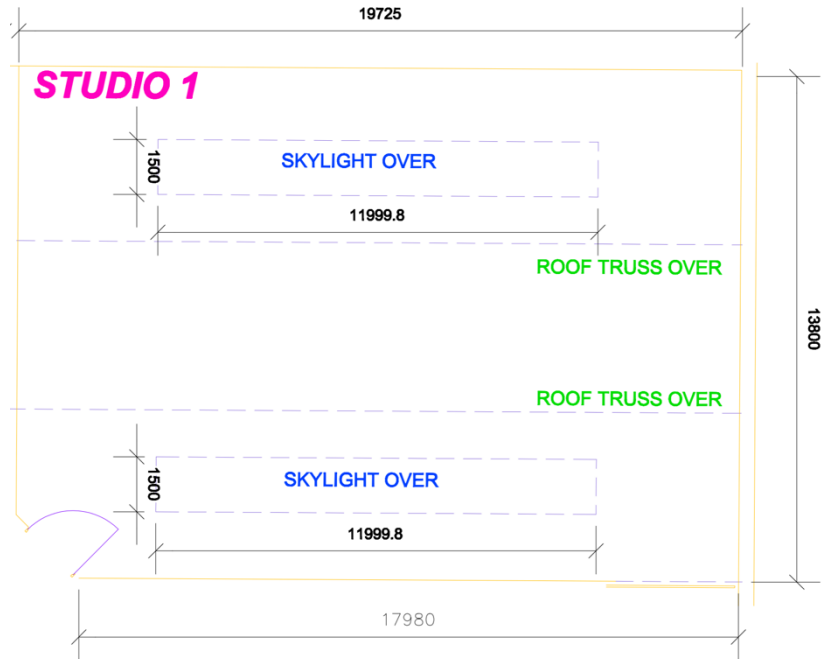

# ROOM SPECIFICATIONS – STUDIO 1

<b>Length</b>	(Wall to wall): 19750mm
<b>Width</b>	(Wall to steel girders): 13750mm
<b>Height</b>	Sloped ceiling with overhead steel truss supports Rigging positions are hung below steel truss supports Floor to roof truss (min): 5200mm Floor to roof truss (max): 5800mm
<b>Building Capacity</b>	Total 200 Pax over both studios & offices and must include all staff & patrons
<b>Seating Bank</b>	Studio 1 features a fully retractable seating bank with a total capacity of 144 patrons
<b>Venue Capacity</b>	Total 160 Pax
<b>Floor</b>	Fully sprung flat floor (no rake) with 19mm ply skin Floor is stained orange to match walls Screwing into the floor is not allowed under any circumstances Harlequin dance floor is able to be laid in Studio 1 on request (Charges Incurred)
<b>Loading Access</b>	General access is via the front door (see Public Access) Door Dimensions are as follows: External door dimensions (W x H): 1250x2650mm Internal door dimensions (W x H): 1660x2680mm Lift load capacity: 630kg Lift dimensions: 1110mm wide x 1250mm deep x 2200mm high. Doors are 900mm wide x 2090mm high
<b>Black Out</b>	All skylights have motorized blinds and can be blacked out <b>Note: This does not provide total blackout during daylight hours</b>
<b>Public Access</b>	Access to Chunky Move is via the ground floor entrance located on the north side of the courtyard between The Malthouse and The ACCA building
<b>Emergency Exits</b>	Via Chunky Move foyer or Malthouse workshop These exits must be kept clear at all times <b>Note: All emergency exits are via stairs</b>
<b>Climate Control</b>	Approx. 22°C controlled by Production & Operations staff
<b>Data/Internet</b>	Internet access available via wireless LAN upon request
<b>Kitchen</b>	Facilities available upon negotiation
<b>Additional Information</b>	Toilets and shower available (shared with office/visitors) Black wool drapes around perimeter of space are hung on Jands heavy duty curtain track. Drapes are designed to fit the entirety of the space <b>Note: Depending on current setup of the space, a cost may be incurred for installation and/or removal of the drapes</b> Atmospherics (smoke/haze) may be used in our studio with prior approval from the Production & Operations Manager <b>Note: Studios have thermal detectors situated throughout the studio. No particle detectors</b> Please consult with the Chunky Move Production & Operations Manager for further information (details first page)
<b>Power</b>	3 x 32a 3-phase outlet (wilco socket) 3 x Jands 32A HPC Dimmer/Distro 4 x 10a single phase GPO circuits around perimeter
<b>Work Lights</b>	12 x 110w LED (equivalent to 400w tungsten) fixtures hung from roof points Control switch beside studio main door
<b>Sound Equipment</b>	Setup as standard Audio rack with Bluetooth, two microphone inputs (XLR) and two line inputs (RCA & 3.5mm) 2 x RCF Art 712A mounted to wall with Behringer subwoofers in line



## Studio 2

Our more intimate studio, with central skylight, sound system and sprung floor.

Regularly used for rehearsals, creative developments, workshops, presentations, and classes.

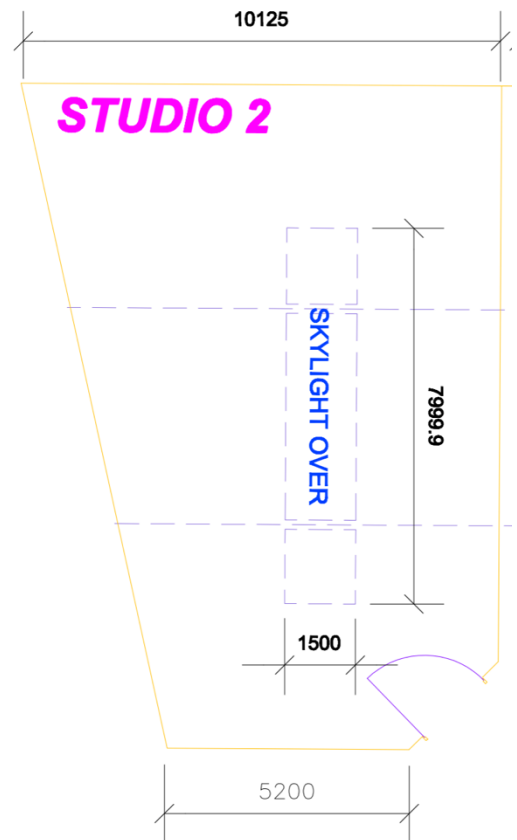

## ROOM SPECIFICATIONS – STUDIO 2

<b>Length</b>	(Wall to steel girders): 13750mm
<b>Width</b>	(Wall to wall – Room narrows to south end): 7000mm – 9000mm
<b>Height</b>	Sloped ceiling with overhead steel truss supports Rigging positions are hung below steel truss supports Floor to roof truss (min): 5271mm Floor to roof truss (max): 5730mm
<b>Building Capacity</b>	Total 200 Pax over both studios & offices and must include all staff & patrons
<b>Venue Capacity</b>	Total 100 Pax
<b>Floor</b>	Fully sprung flat floor (no rake) with 19mm ply skin Floor is stained orange to match walls Screwing into the floor is not allowed under any circumstances Floors are covered with Harlequin dance floor and can be removed/altered upon request (Charges Incurred)
<b>Storage</b>	Cabinetry is located along the rear wall for property of Chunky Move. Please ensure adequate clearance for staff access.
<b>Loading Access</b>	General access is via the front door (see Public Access) Door Dimensions are as follows: External door dimensions (W x H): 1250x2650mm Internal door dimensions (W x H): 1660x2680mm Lift load capacity: 630kg Lift dimensions: 1110mm wide x 1250mm deep x 2200mm high. Doors are 900mm wide x 2090mm high
<b>Black Out</b>	All skylights have motorized blinds and can be blacked out <b>Note: This does not provide total blackout during daylight hours</b>
<b>Public Access</b>	Access to Chunky Move is via the ground floor entrance located on the north side of the Courtyard between The Malthouse and The ACCA building
<b>Emergency Exits</b>	Via Chunky Move foyer or Malthouse workshop These exits must be kept clear at all times <b>Note: All emergency exits are via stairs</b>
<b>Climate Control</b>	Approx. 22°C controlled by Production & Operations staff
<b>Data Points</b>	Internet access available via wireless LAN upon request
<b>Kitchen</b>	Facilities available upon negotiation
<b>Additional Information</b>	Toilets and shower available (shared with office/visitors) Atmospherics (smoke/haze) may be used in our studio with prior approval from the Production & Operations Manager <b>Note: Studios have thermal detectors situated throughout the studio. No particle detectors</b> Please consult with the Chunky Move Production & Operations Manager for further information (details first page)
<b>Power</b>	1 x 20a 3-phase outlet (wilco socket) 3 x 10a single phase GPO circuits around perimeter
<b>Work Lights</b>	6 x 110w LED Floor (equivalent to 400w tungsten) fixtures hung from roof points Control switch beside studio main door
<b>Sound Equipment</b>	Setup as standard Audio rack with Bluetooth, two microphone inputs (XLR) and two line inputs (RCA & 3.5mm) 2 x RCF 310A Powered mounted to wall

# ACCESS

Chunky Move is committed to the visibility and value of all bodies and reflects this in our programming. We seek to create and maintain an inclusive and accessible environment and recognise this requires the building and nurturing of meaningful, collaborative relationships with diverse communities, creatives and leaders.

We encourage hirers to consider access in their activities here at Chunky Move's Southbank Studios.

## Wheelchair / Flat Access

Chunky Move is fully wheelchair accessible via a lift at the main entrance, with a wheelchair accessible bathroom.

## Car Parking

There are two car spaces for deaf, disabled and Neurodiverse people or artists on Sturt Street, right outside the ACCA entrance. If you require closer access to our building please call ahead on (03) 9645 5188 or contact the National Relay Service [here](#) and a team member from Chunky Move will be able to assist you.

## Assistance Dogs

Guide and assistance dogs are welcome at Chunky Move. Open grassed areas are located nearby at the park on corner of Grant and Dodds Street.

## Taking Public Transport to Chunky Move

If taking Public Transport, there are two tram journey options. Both options connect with Flinders Street Station:

Take Route 1, which travels along Sturt Street and straight to ACCA's front door. Alight at Stop 18/Grant Street. Continue south down Sturt Street to ACCA's front door at 111 Sturt Street. If you are standing facing the ACCA front doors, you will see a courtyard on the right side of this building. Enter the courtyard and towards the end on the left of the courtyard is a large Chunky Move sign. This is our front door. Walk towards this sign.

Alternatively, Take Routes 3, 5, 16, 64, 67, 72 along St Kilda Road. Alight at Stop 17/Grant Street Police Memorial (accessible tram stop). Cross St Kilda road, and continue down Grant Street. Walk past the big yellow sculpture and through the large undercroft towards a courtyard, you will be on a gravel surface. The door glass to our building is immediately on your right once you walk through the undercroft.

For further information on how to access Chunky Move via public transport, please view the video produced by RISING below on our website. <https://chunkymove.com/accessibility/>. A version is also available in Auslan on the same page.

## Social Story for Visiting Chunky Move

This is a step-by-step visual and written guide for visitors to Chunky Move to help visitors to plan their visit. This social story provides information on how to access the Chunky Move building, what to expect when you enter, and who to ask for assistance.

You download it [here](#) and if you wish to, edit these stories and tailor to your planned visit, or watch the social story in Auslan [here](#).

## Contact Chunky Move

If you have any suggestions to help us continue improving our access services, or would like any information in another format, please don't hesitate to contact us:

Telephone 03 9645 5188

Email [info@chunkymove.com.au](mailto:info@chunkymove.com.au)

Chunky Move is contactable through the National Relay Service [here](#) or the Chunky Move Office 03 9645 5188.



## **HIRER'S OBLIGATIONS**

The Hirer's obligations are outlined in detail in the Venue Hire Agreement.

They include the following:

### **Permitted Use**

The studio will be made available to the Hirer during normal office hours, 9:00am to 5:30pm on weekdays. Hire periods outside of these hours will incur additional charges to cover the cost of Front of House staff.

Chunky Move may require the use of the studio outside of the hours of the hire period (i.e. in the mornings/evenings/weekends for Chunky Move dance classes). It is agreed that the Hirer will leave the space clear of any props, furniture etc. on a daily basis throughout the hire period, unless otherwise negotiated in advance with Chunky Move.

### **Prohibited Uses**

The Hirer shall not use or permit the use of hard shoes, stilettos or sharp edges on the Harlequin dance floor. Any naked flame or similar devices in the studio is prohibited. Nor shall the Hirer permit any person to smoke a cigarette, cigar, pipe or vape in any part of the building.

The Hirer will submit a risk register when confirming the studio hire. All risks and hazards are to be discussed with the Production & Operations Coordinator (details first page) prior to use of the space.

### **Electrical Equipment**

All Electrical equipment used in the Chunky Move studios that is not the property of Chunky Move must be tested and tagged at the Hirer's expense prior to the commencement of the hire using the Chunky Move facilities. Onsite test and tagging can be provided with negotiation in advance.

### **Insurance**

The Hirer must obtain the appropriate insurance, such as public liability insurance and workers compensation insurance for employees of the Hirer.

### **Damage to the Building**

The Hirer shall not under any circumstance cause or allow to be caused any damage to the building including equipment.

In the event damage occurs, the Hirer must notify Chunky Move of any damage at the time of its occurrence.

Any costs associated with damage that occurs as a direct result of the Hirer's use will be the Hirer's responsibility, as determined by Chunky Move.

### **Rubbish**

Chunky Move facilities provide general waste and recycling receptacles. Reasonable quantities of waste may be disposed of at Chunky Move. Excess waste must be removed from the building by the hirer. If additional bin pickups are required as part of the hire, this cost will be passed onto the hirer.